

# HOBIE WAVE

REPLACEMENT HULL - LEFT 39010001  
 REPLACEMENT HULL - RIGHT 39020001

## WAVE VERSION NOTES:

**STANDARD WAVE / CLASSIC OR "SE"** - (CAR TOPPABLE) ONE PIECE TRAMPOLINE, SHROUDS AND BRIDLES CONNECT WITH HOOKS  
**CLUB WAVE** -THREE PIECE TRAMPOLINE. SHROUDS AND BRIDLES CONNECT WITH CLEVIS PINS  
*CLUB items listed only if different from standard SE wave model.*

## CLASSIC / SE WAVE

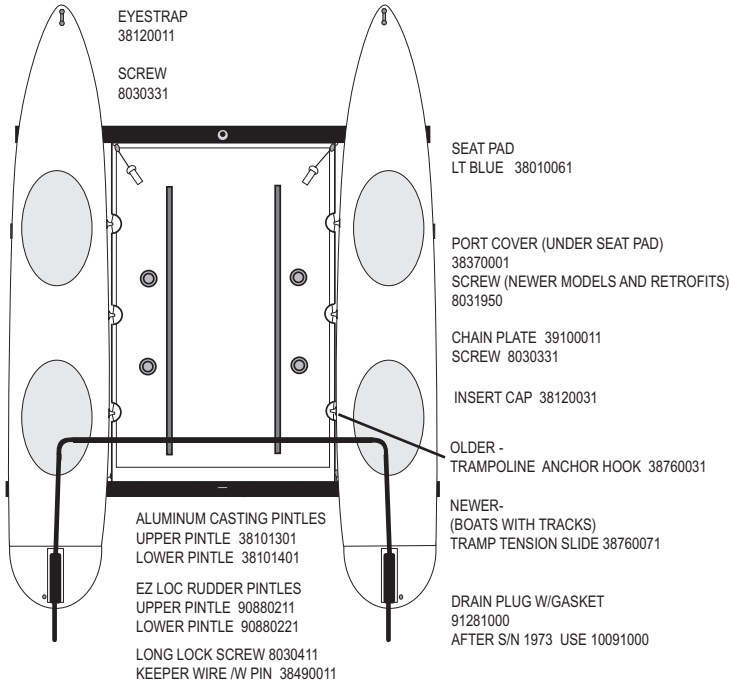

### '97-NEWER

(SN 1438-ABOVE)

**FORWARD CROSSBAR** 38131041

**MAST STEP CASTING** 38171001  
**POST (THREADED)** 38170001  
**BALL** 50212301  
**BASE STEP PIN** 8020451

### '96-OLDER

**MAST STEP CASTING** 10170001  
**MAST STEP LINK KIT** 21380001

**FORWARD END CAP** 38130031

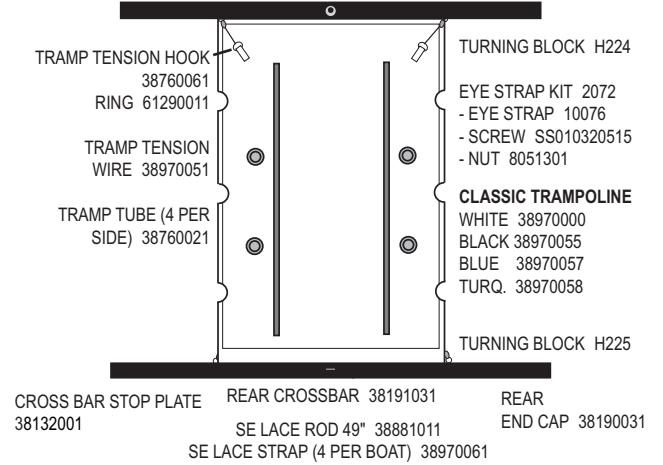

## CLUB WAVE

( CLUB WAVE VERSION-ITEMS LISTED BELOW ONLY IF DIFFERENT FROM STANDARD WAVE MODEL. )

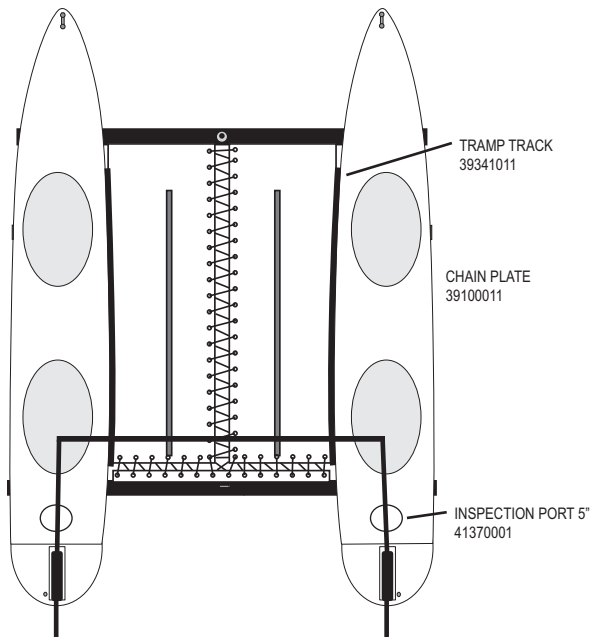

### ACCESSORY PARTS

**BOW SPREADER** 38999021  
**END CAP** 38950011  
**BOW SPREADER TANG** 38120041

**SEAT BACKREST KIT** 38040011  
**BACKREST INSTALLATION QUICK PIN** 8020181

**BACKREST PLUG, FORWARD** 38660011  
**BACKREST PLUG, AFT** 38660031

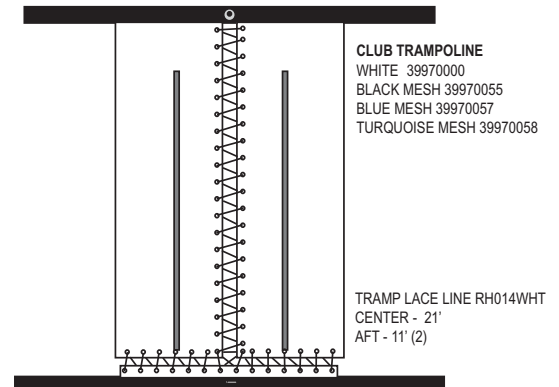

**TILLER CROSS BARS**

- 39521001 CLUB BOLT
- 39522001 TENDON
- 39524001 '07 EZ LOC

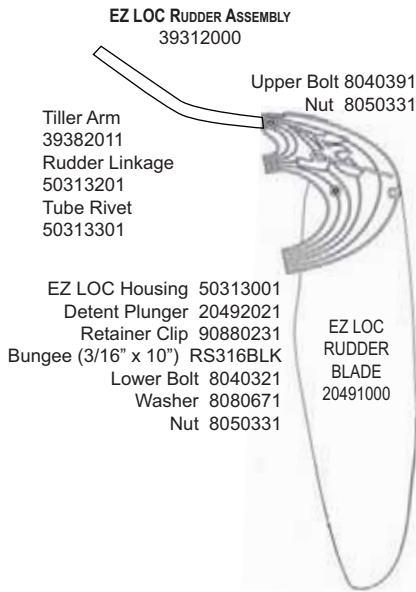

**RUDDER ASSEMBLY**  
Pre-"EZ LOC" Rudder System  
\* = SUB ASSEMBLY PART / INCLUDED WITH CASTING

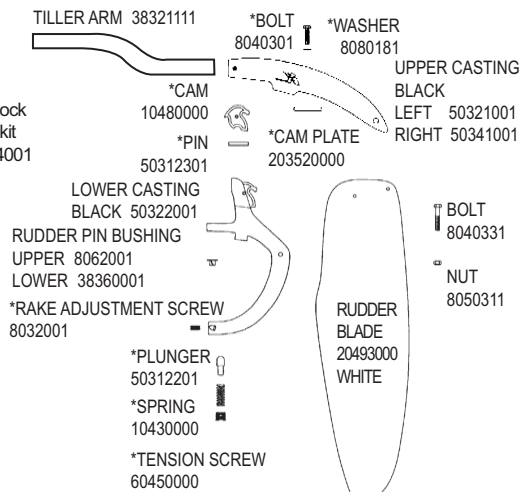

- FLOAT KIT 30115
- BRACKET (1) 39640020
- SCREW 8032011
- MAST HEAD 10602111

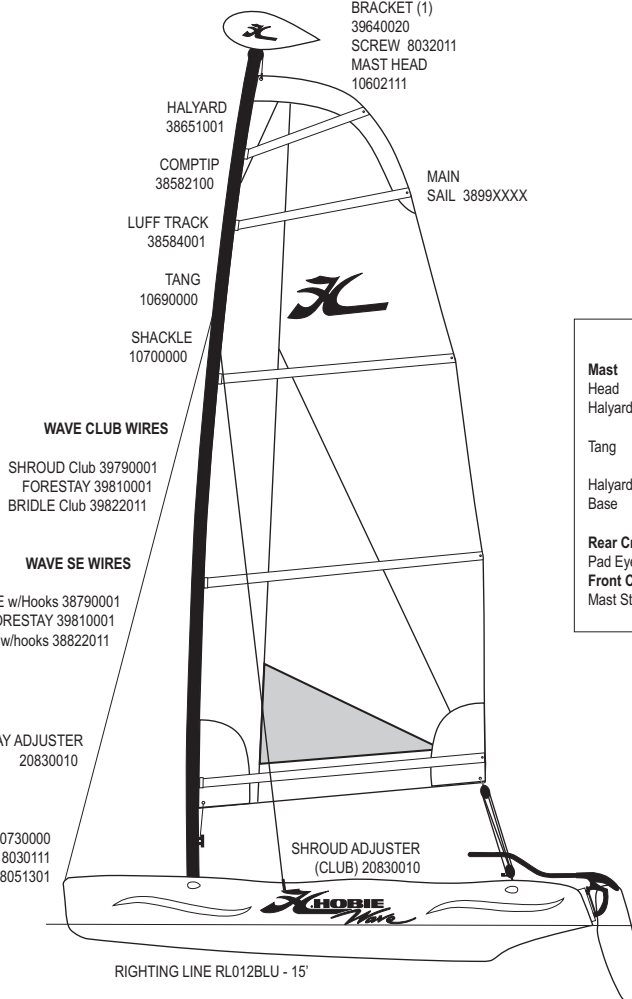

**TILLER CONNECTOR KITS AND PARTS**

- 1957 KIT - '07 TILLER CONNECTOR
- 1956 KIT - CLUB TILLER CONNECTOR (REPLACES TENDON STYLE WITH CLUB BOLT STYLE)
- 1954 KIT - CLUB TILLER CONNECTOR / UPGRADE FOR EARLY BOATS WITH ORIGINAL CURVED TENDON CONNECTORS: INCLUDES TILLER CROSS BAR AND ALL TILLER CONNECTOR FITTINGS

**'07 TILLER CONNECTOR (1957)**

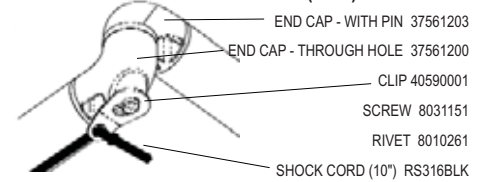

**CLUB TILLER CONNECTOR (1954 / 1956)**

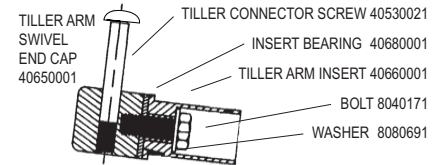

**TENDON TILLER CONNECTOR**

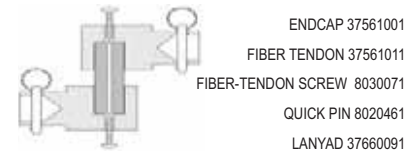

38016001 HOBIE WAVE BATTEN SET

(FOR INDIVIDUAL BATTENS SEE UNIVERSAL BATTENS ON PAGE 18)

**MAST**

**SERIAL NUMBER 0 THROUGH 1437**  
OLD ASSEMBLY NLA (SEE NEW STYLE BELOW) CONVERSION REQUIRES MAST STEP RETROFIT.  
MAST BASE (HOBIE14 STYLE) 10640011

**SERIAL NUMBER 1438 AND NEWER**  
MAST ASSEMBLY (NEW STYLE) 38581041  
LOWER MAST 38583141  
NEW MAST BASE (CUP) 38641001

**MAST STEP PARTS**

- (\*Conversion parts required to retrofit new mast to old style boat):
- \*NEW STEP BALL 50212301
- \*NEW STEP POST 38170001
- \*NEW MAST STEP CASTING 38171001 (Flat top / threaded for post)
- \*RIVET (4) 8011231
- \*STEP PIN -8020451

**Wave Rivet Guide ( ) Quantity needed to fasten part**

	Quantity		Quantity
<b>Mast</b>		<b>Rudder Assembly</b>	
Head	8010131 (2)	Upper Casting	8010131 (2)
Halyard Hook	8010181 (2)	(Underside)	8011231 (1)
	8011291 (2)	Tiller End Cap	8010131 (2)
Tang	8010181 (6)		
	8011291 (6)	<b>Sail</b>	
Halyard Cleat	8010121 (2)	Headboard	8010020 (16)
Base	8010131 (3)	Tack/Clew plate	8010020 (6)
		Pocket Protector	8010020 (4)
<b>Rear Crossbar</b>		(Requires setting machine-not available as hand tool)	
Pad Eye	8010181 (2)		
<b>Front Crossbar</b>			
Mast Step	8011231 (4)		

"S" HOOK 38900031  
SHACKLE 11220000

UPPER BLOCK 38900061

RM516BLU X 35'

LOWER BLOCK 38900071